

**(en) Set-Up Instruction / Operator's Manual
LED Balloon Light**

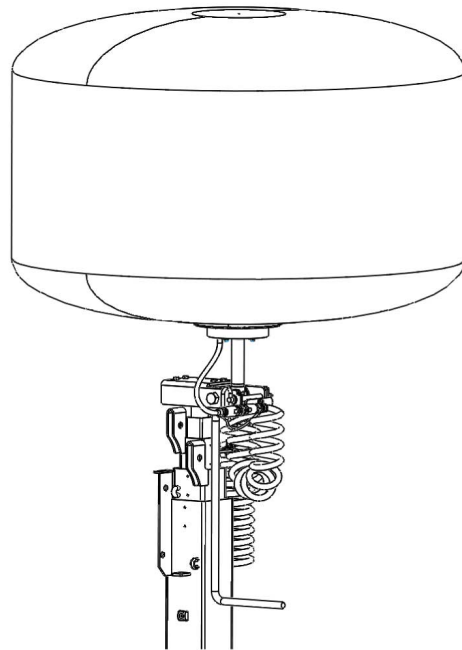

Record Important Information

Recording the equipment information will help when placing an order for replacement parts and/or decals.

Company Equipment No:	
Unit Model No:	
Unit VIN:	
Engine Model No:	Serial No:
Generator Model No:	Serial No:
Accessories:	

Manual Contents:

Introduction.....	2
Safety.....	2
Installation.....	4
Operation.....	5
Transport.....	5
Maintenance.....	5
Troubleshooting.....	5
Specifications.....	6

Introduction

About This Manual

TAKE TIME TO READ THIS MANUAL THOROUGHLY

This instruction manual provides necessary instructions for the Allmand® LED Balloon Light Attachment.

The information found in this manual is in effect at the time of printing. Allmand Bros Inc. may change contents without notice and without incurring obligation.

The images throughout this manual are representative, and may differ from your model.

Any reference in this manual to left or right shall be determined by looking at the trailer from the rear.

If uncertain about any of the information in the manual, contact the Allmand service department at 1-800-562-1373, or contact us through the Allmand website, www.allmand.com.

Save these original instructions for future reference.

Safety

Safety Definitions

For your safety, the safety of others, and to protect the performance of equipment, follow the precautions listed throughout the manual before operation, during operation and during periodic maintenance procedures.



Indicates a potential personal injury hazard.

DANGER

Indicates a hazardous situation which, if not avoided, will result in death or serious injury.

WARNING

Indicates a hazardous situation which, if not avoided, could result in death or serious injury.

CAUTION

Indicates a hazardous situation which, if not avoided, could result in minor or moderate injury.

NOTICE

Information considered important but not hazard related.

Safety Precautions

The following section contains general safety precautions and guidelines that must be obeyed to reduce risk to personal safety. Special safety precautions are listed in specific procedures. Read and understand all of the safety precautions before operating or performing repairs or maintenance.



DANGER

Electrocution Hazard

- Always check overhead wires and obstructions before raising or lowering the light tower.
- Always obey the rules or instructions for your work site and state, province and national electric code for maintaining a safe distance from overhead wires.
- High voltage is present when engine is running. Never attempt to service electrical components while engine is running.
- Do not operate the light tower if the insulation on the electrical cord or other electrical wiring is cut or worn or if bare wires are exposed. Repair or replace damaged wiring before starting the engine.



WARNING

Unsafe Operation Hazard

- Never permit anyone to install or operate the equipment without proper training.
- Read and understand this Operator's Manual, the Engine Operator's Manual, and any other component manuals before operating or servicing the light tower to make sure that safe operating practices and maintenance procedures are followed.
- Safety signs and decals are additional reminders for safe operating and maintenance techniques.



WARNING

Fall Hazard

- Never carry riders on the equipment.



WARNING

Modification Hazard

- Never modify the equipment without written consent of the manufacturer. Any modification could effect the safe operation of the equipment.



WARNING

Exposure Hazard

- Always wear personal protective equipment, including appropriate clothing, gloves, work shoes, and eye and hearing protection, as required by the task at hand.



WARNING

Rollover Hazard

- Do not raise, lower or use light tower unless all outriggers and jacks are positioned on firm ground.
- Never move or reposition the light tower while the light tower is extended in the vertical position.



WARNING

Fire and Explosion Hazard

Batteries give off explosive gases during recharging. Sparks could cause explosions, resulting in death or serious injury.

Burn Hazard

Batteries contain acid, which is extremely caustic. Contact with battery contents could cause severe chemical burns.

Shock Hazard

Batteries present a risk of electric shock and high short circuit current.

- Always disconnect the negative (-) battery cable before servicing equipment.
- DO NOT dispose of battery in a fire. Recycle battery.
- DO NOT allow any open flame, spark, heat, or lit cigarette during and for several minutes after charging a battery.
- DO NOT open or mutilate battery.
- DO NOT charge a frozen battery. Always slowly warm the battery to room temperature before charging.
- Wear protective gloves, rubber apron, rubber boots and rubber gloves.
- Remove watches, rings, or other metal objects.
- Use tools having insulated handles.



WARNING



Fire And Explosion Hazard

- Diesel fuel is flammable and explosive under certain conditions.
- Never use a shop rag to catch fuel.
- Wipe up all spills immediately.
- Never refuel with the engine running.
- Store any containers containing fuel in a well ventilated area, away from any combustibles or sources of ignition.



WARNING

Alcohol And Drug Hazard

- Never operate the light tower while under the influence of alcohol or drugs, or when ill.



WARNING

Entanglement / Severe Hazard

- Always stop the engine before beginning service.
- If the engine must be serviced while it is operating, remove all jewelry, tie back long hair and keep hands, other body parts and clothing away from moving/rotating parts.
- Verify that all guards and covers are attached properly to the equipment before starting the engine. Do not start the engine if any guards or covers are not properly installed on the equipment.
- Attach a "Do Not Operate" tag near the key switch while performing maintenance on the equipment.



WARNING

Flying Object Hazard

- Always wear eye protection when cleaning the equipment with compressed air or high pressure water. Dust, flying debris, compressed air, pressurized water or steam may injure your eyes.



WARNING

Coolant Hazard

- Wear eye protection and rubber gloves when handling engine coolant. If contact with the eyes or skin should occur, flush eyes and wash immediately with clean water.



WARNING

Burn Hazard

- Opening cap on hot radiator could result in death or serious injury. Allow radiator to cool down before opening cap.

WARNING

Burn Hazard

- Light fixtures and some of the engine surfaces become very hot during operation and shortly after shutdown.
- Keep hands and other body parts away from hot surfaces.
- Handle hot components, such as light fixtures, with heat resistant gloves.

NOTICE

- Any part which is found defective as a result of inspection or any part whose measured value does not satisfy the standard or limit **MUST** be replaced.
- Always tighten components to the specified torque. Loose parts can cause equipment damage or cause it to operate improperly.
- Follow the guidelines of the Environmental Protection Agency (EPA), Environment Canada (EC) or other governmental agencies for the proper disposal of hazardous materials such as engine oil, diesel fuel and engine coolant.
- Only use replacement parts specified. Other replacement parts may effect warranty coverage.
- Clean all accumulated dirt and debris away from the body of the equipment and its components before you inspect the equipment or perform preventative maintenance procedures or repairs. Operating equipment with accumulated dirt and debris will cause premature wear of equipment components.
- Never dispose of hazardous materials by dumping them into a sewer, on the ground, or into groundwater or waterways.
- Retrieve any tools or parts that may have dropped inside of the equipment to avoid improper equipment operation.
- If any alert indicator illuminates during equipment operation, stop the engine immediately. Determine the cause and repair the problem before continuing to operate the equipment.

It is a violation of California Public Resource Code, Section 4442, to use or operate the engine on any forest-covered, brush-covered, or grass-covered land unless the exhaust system is equipped with a spark arrester, as defined in section 4442, maintained in effective working order. Other states or federal jurisdictions may have similar laws; reference Federal Regulation 36 CFR Part 261.52.

Safety Decals

Before operating your unit, read and obey the following safety decals. The cautions, warnings, and instructions are for your safety. To avoid personal injury or damage to the unit, understand and obey all the decals.

Keep the decals from becoming dirty or torn, and replace them if they are lost or damaged. Also, if a part needs to be replaced that has a decal attached to it, make sure to order the new part and decal at the same time.

If any safety or instructional decals become worn or damaged, and cannot be read, order replacement decals from your dealer.

WARNING - Failure to secure balloon light in upright position before machine operation could result in death or serious injury. Secure balloon light in upright position before operation.

Part No. 118360

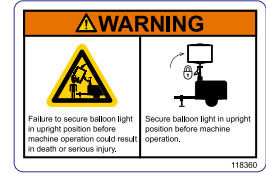

WARNING - Failure to remove balloon light before transporting could result in death or serious injury. Remove balloon light before transporting.

Part No. 118361

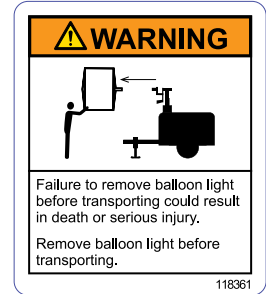

Installation

Before Installation

1. Lower the light tower to the transport position. Refer to the light tower operator's manual.
2. Shut down the light tower. Refer to the light tower operator's manual.

Install the Light

WARNING

Electrocution Hazard

Electrocution hazard could result in death or serious injury.

Attempting to install the balloon light onto the light tower without first shutting down the unit will result in death or serious injury. Shut down the light tower and disconnect the battery before installing the balloon light.

1. Remove the clevis pin (A, Figure 1) from the balloon light mount.
2. Lift the mount swing handle (B) to turn the balloon light mount to a horizontal position.
3. Remove the balloon light from the hard plastic container and cloth bag.

CAUTION

The balloon light shade will expand when the balloon light is removed from the container and bag.

4. Install the end of the balloon light (C) into the mount tubing (D). Make sure that the button clip (E) locks into the hole in front of the mount tubing.

Note: The balloon light and mount tubing are shown vertical. The balloon light shade is not shown expanded.

- Using the mount swing handle, turn the balloon light to a vertical position. Install and lock the clevis pin (A) to lock the balloon light in the vertical position.

WARNING
Crush Hazard

Crush hazard could result in death or serious injury.

Failure to lock the balloon light in the vertical position with the clevis pin before machine operation could result in death or serious injury. Always lock the balloon light in the vertical position with the clevis pin before operation.

- Connect the balloon light harness (F) to the light tower harness (G).

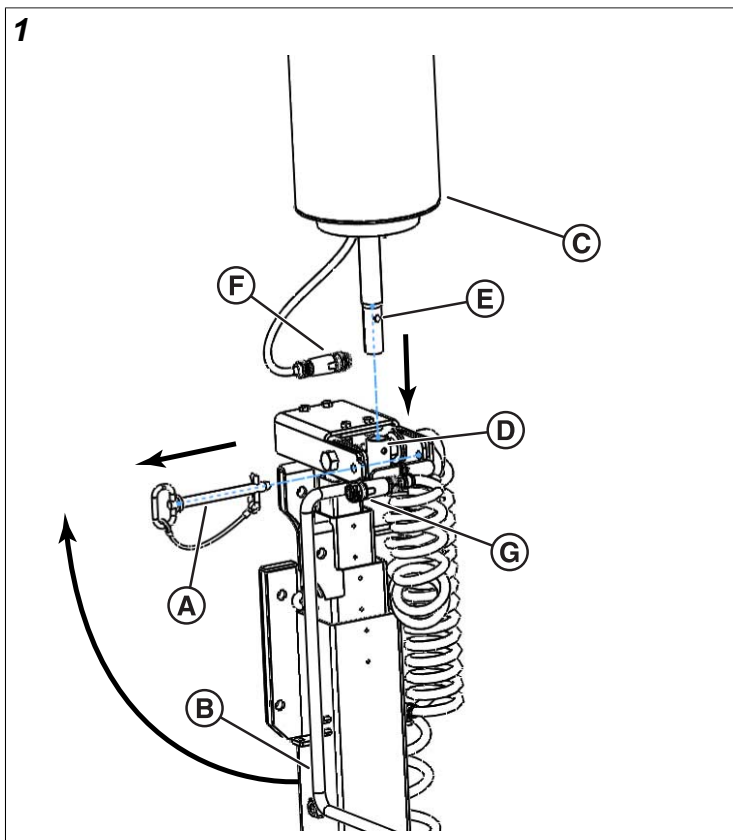

Operation

The balloon light is controlled by the light tower control panel. Unlike the light fixtures that come standard with the light tower, the position of the balloon light is fixed and cannot be adjusted.

Refer to the Operation section of the light tower Operator's Manual for instructions regarding operation.

WARNING

Rollover Hazard

Rollover hazard could result in death or serious injury.

Using the balloon light reduces maximum continuous wind load by 10 mph (16 km/h). Refer to the light tower Operator's Manual.

Transport

The balloon light must be removed from the light tower before transporting the light tower.

- Shut down the light tower and turn off the engine. Refer to the light tower Operator's Manual.
- Disconnect the balloon light harness from the light tower harness.
- Holding the mount swing handle in place, remove the clevis pin.
- Lift the mount swing handle to move the balloon light to a horizontal position.
- Push in the button clip locking the balloon light in the mount tubing, and remove the balloon light from the mount tubing.
- Lower the mount swing handle and install and lock the clevis pin.
- Push the air out of the balloon light shade to make it as compact as possible, and put the balloon light into the cloth bag and hard plastic container.
- Refer to the Transport section of the light tower Operator's Manual for further instructions on transporting the light tower.

Maintenance

Balloon Light Shade Repair

- Cut a patch from the self-adhesive fabric sheet in the repair kit. Cut it big enough to fully cover the damaged area of the balloon light shade.
- Clean the area of the balloon light shade where the patch will be applied.
- Remove the protective film from the self-adhesive side of the patch.
- Apply the patch to the damaged area of the balloon light shade.

Troubleshooting

Before troubleshooting, see **Safety**.



WARNING

Electrocution Hazard

- High voltage is present when engine is running. Never attempt to service electrical components while engine is running.
- Contact with wires made bare by damaged, cut or worn insulation could result in death or serious injury. Replace damaged wiring before operating unit.

Problem	Possible Cause	Remedy
Light(s) not operating	Balloon light harness not connected to light tower harness.	Connect balloon light harness to light tower harness.

For all other issues, see your authorized dealer.

Specifications

Height *	31.5 in (80 cm)
Diameter (not counting balloon light shade)	9 in (23 cm)
Diameter (with balloon light shade fully expanded)	48 in (122 cm)
Weight *	28 lbs (12,7 kg)

* Not including mounting components

